



 Four magnetic bars (two pairs) in beechwood - light or dark. Post-it glue on surface and strong magnetism to keep the poster in place. Thin felt lining protects your poster from marks. Can be used single and double sided. Easy installation.

 4 Buchenholzleisten (zwei Paar) - hell oder dunkel - mit Magneten. Post-it-Kleber auf der Oberfläche und starker Magnetismus, um das Poster zu halten. Dünner Filz schützt Ihr Poster vor Flecken. Kann ein- und doppelseitig verwendet werden. Leicht zusammenzubauen.

 Fire magnetstænger (to par) i bøgetræ - lys eller mørk. Post-it lim på overfladen og stærke magneter for at holde plakaten på plads. Tyndt filt beskytter din plakat mod mærker. Kan bruges enkelt- og dobbeltsidet. Let at montere.



Model	Article	Color	Length	Product	Package size and weight	Pallet size and quantity		
457	2651	Light wood	30 cm		cm	kg	cm	pcs.
457	2652	Light wood	40 cm		cm	kg	cm	pcs.
457	2653	Light wood	50 cm		cm	kg	cm	pcs.
457	2654	Light wood	60 cm		cm	kg	cm	pcs.
457	2641	Dark wood	30 cm		cm	kg	cm	pcs.
457	2642	Dark wood	40 cm		cm	kg	cm	pcs.
457	2643	Dark wood	50 cm		cm	kg	cm	pcs.
457	2644	Dark wood	60 cm		cm	kg	cm	pcs.

Wood Poster Hanger Magnetic

Each set includes: 2 sets of magnetic wood poster holders and a printed map.

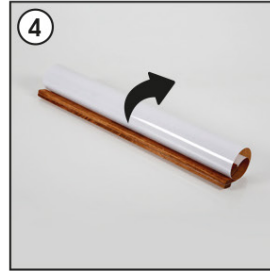
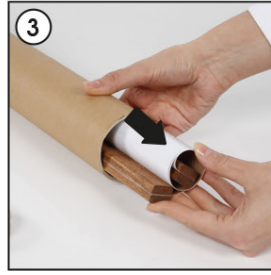
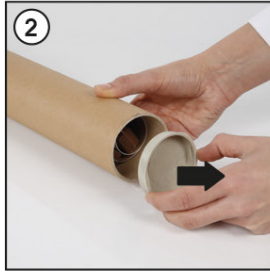
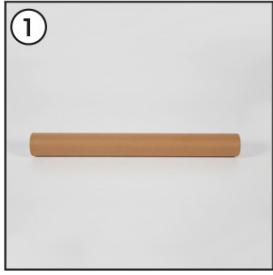

Attaching poster

