

 Solid aluminum stand with heavy foot. Mounted with 8 pcs. of holders in polycarbonate for A4 brochures. Logoplate in size 45 x 16 cm. For indoor use.

 Stabiler Ständer aus eloxierter Aluminium mit schwerem Fuß. Bestückt mit 8 Stück Hälter aus Polycarbonat für A4 Prospekte. Logoplatte mit Maß 45 x 16 cm. Für den Innenbereich.

 Solid aluminium stander med tung fod. Monteret med 8 stk. holdere i polycarbonat til A4 brochurer. Logoplade i størrelsen 45 x 16 cm. Til indendørs brug.



Model	Article	Capacity	Color	Total W x H	Base	Weight	Pallet size and quantity
920	2872	8 x M65 holders	Alu / Acrylic	45 x 190 cm	Ø 45 cm	22 kg	80 x 120 x 220 cm 20 pcs.
920	2873	8 x A5 holders	Alu / Acrylic	45 x 190 cm	Ø 45 cm	25 kg	80 x 120 x 220 cm 20 pcs.
920	2874	8 x A4 holders	Alu / Acrylic	58 x 190 cm	Ø 45 cm	28 kg	80 x 120 x 220 cm 20 pcs.

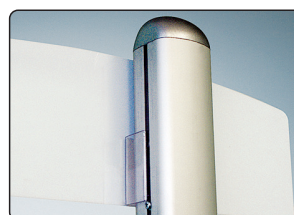
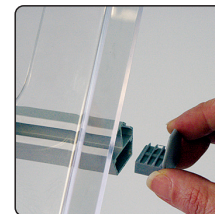
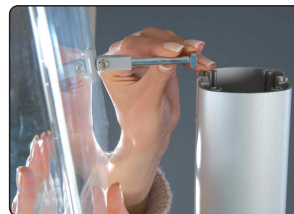
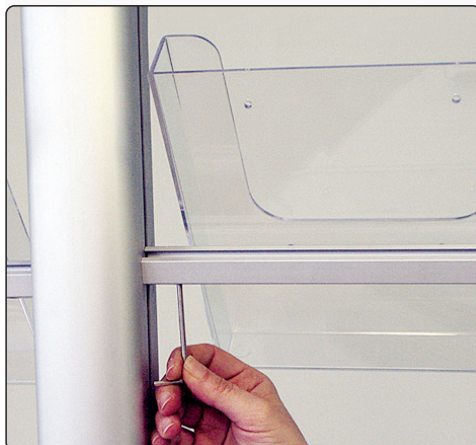
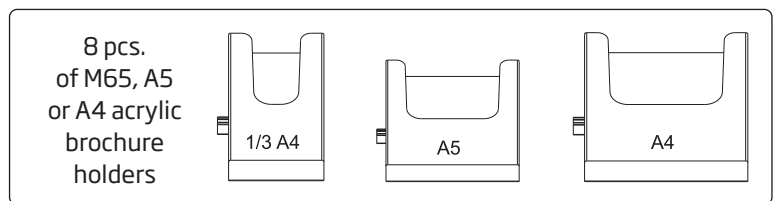
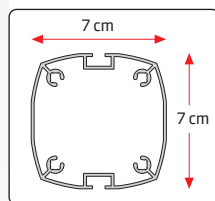
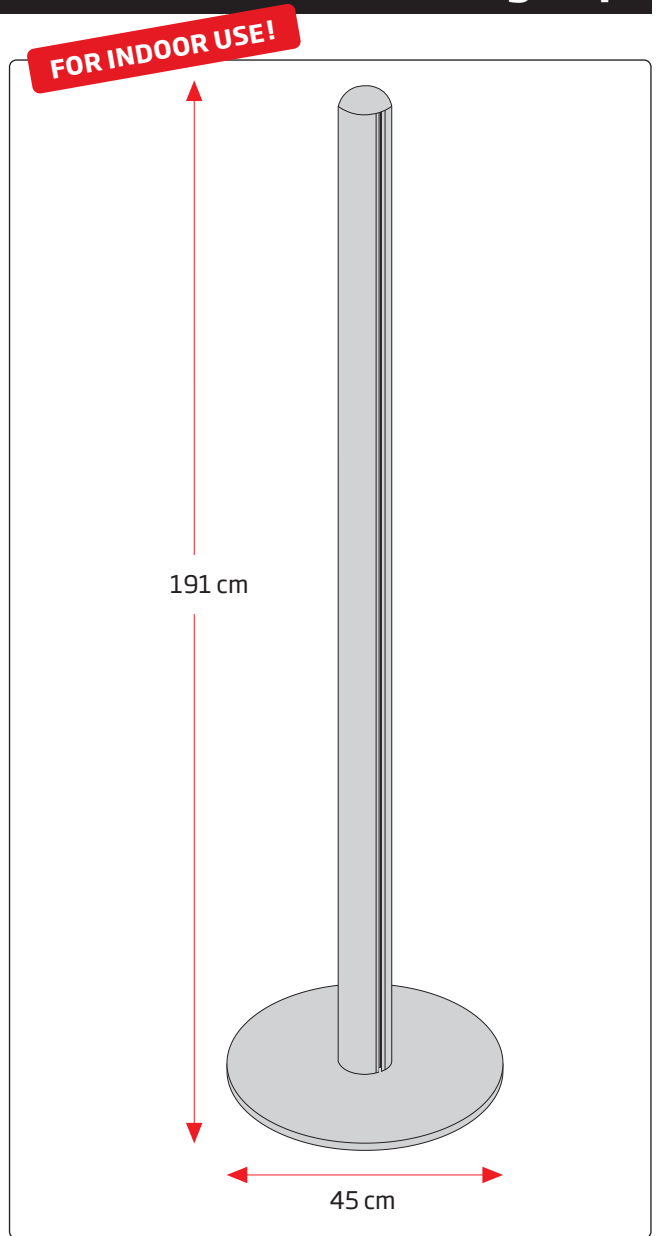
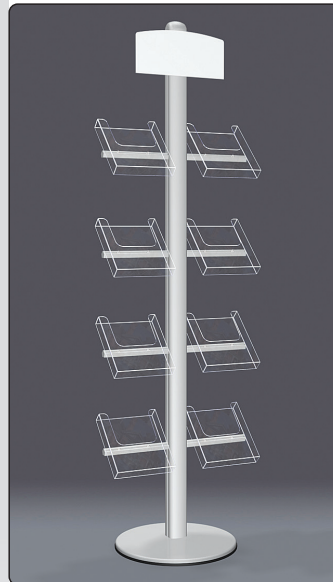

- Slide the shelf stand profile through the pole's channel, fix it on the desired position.
- Ablage profil durch den Kanal schieben. In der erwünschten Höhe mit Inbusschlüssel festziehen.

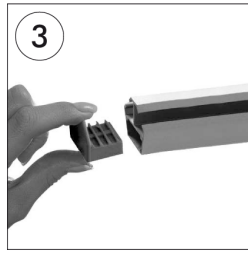
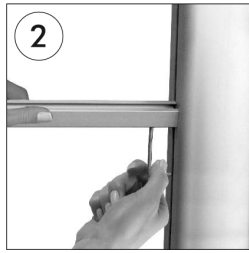

- Take off the end cap on the shelf stand profile.
- Endkappe am Ablageprofil abnehmen.

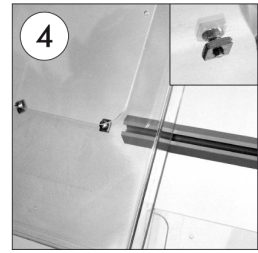

- Slide the transparent shelves connectors through the channel of the shelf stand profile
- Die Mutter an der transparenten Ablage durch Kanal durchstechen.

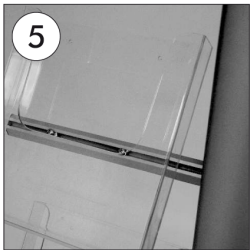

- Place the shelf to the suitable position. Hold it tight by screwing.
- Bringen Sie die Ablage in die richtige Position und ziehen Sie die darauf befindliche Schrauben fest.

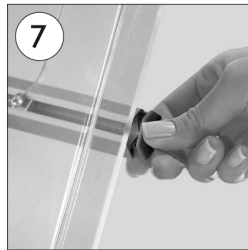
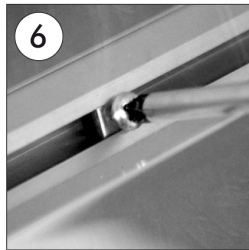

- Put the end caps back on the shelf stand profile.
- Die Endkappe darauf stechen.

